

POS.	DESCRIPTION	MATERIAL	QTY
1	modified flange DN63 CF	1.4404 (316L)	1
2	9 pin SUB-D f/t	stainless steel	4

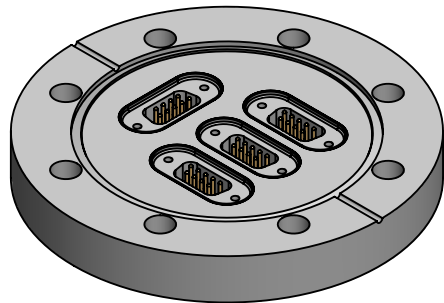
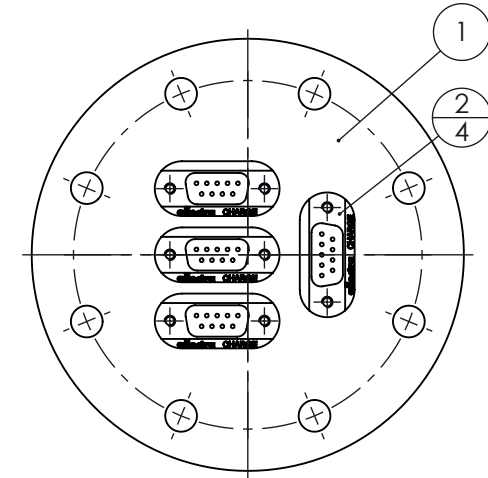
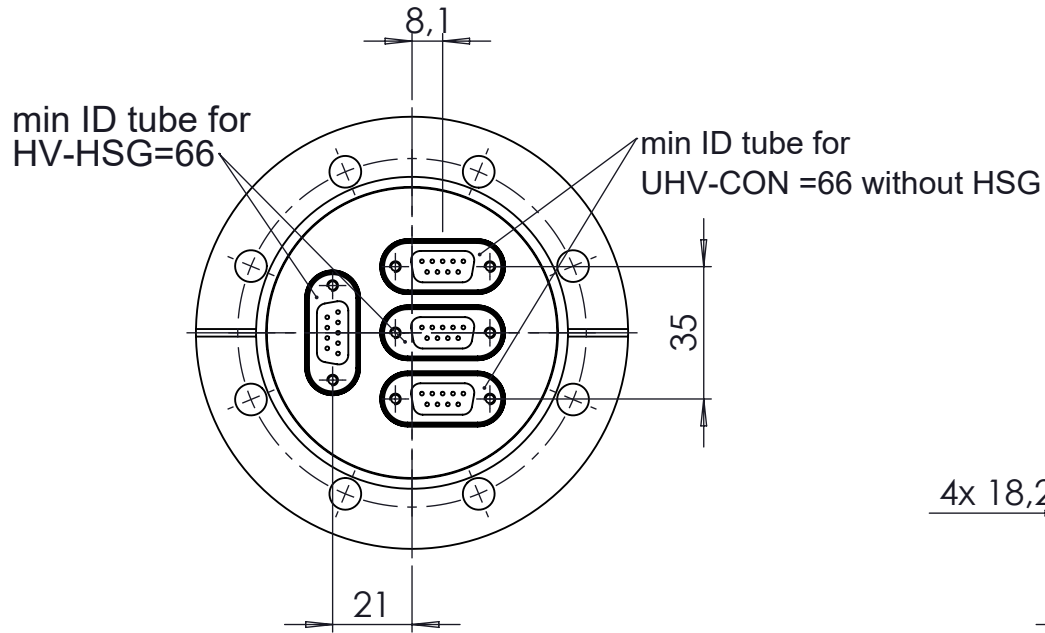

All informations provided in this drawing is considered to be confidential, proprietary and secret information. It is intended only for the use of individual or entity to whom it is sent. Individual or entity agrees to not disseminate or copy this information to anyone other than originally specified without the written consent Allectra GmbH.		Verwendetes Material (USED MATERIAL)		Bemerkung (REMARKS)		Kanten (EDGES)		PROJECTION																
		UHV-CON=66, 2x HSG=66				Maßstab (SCALE): 1:2		Gewicht (WIGHT): 1151.87g																
Oberfläche (SURFACE) Cleaned UHV- Compatible		Rauheit (ROUGHNESS) √		Werkstoff (MATERIAL):		Bl. (page) A4		page 1																
origin name Allectra standard origin (drw/sketch/part no) date of origin		<table border="1"> <thead> <tr> <th></th> <th>DATE</th> <th>NAME</th> </tr> </thead> <tbody> <tr> <td>Design</td> <td>17.12.2014</td> <td>JB</td> </tr> <tr> <td>Drawn</td> <td>09.10.2023</td> <td>AD</td> </tr> <tr> <td>Check</td> <td>09.10.2023</td> <td>JB</td> </tr> <tr> <td>Approv</td> <td>09.10.2023</td> <td>JB</td> </tr> </tbody> </table>			DATE	NAME	Design	17.12.2014	JB	Drawn	09.10.2023	AD	Check	09.10.2023	JB	Approv	09.10.2023	JB	Benennung (DESCRIPTION): 4 off 9 pin SUB-D f/t on flange DN63 CF					
	DATE	NAME																						
Design	17.12.2014	JB																						
Drawn	09.10.2023	AD																						
Check	09.10.2023	JB																						
Approv	09.10.2023	JB																						
00 First origin				Zeich. Nr. (Drw. No.): 210-D09-C63-4				REV 00																
REV Beschreibung (CHANGING)				LAST SAVE DAT.: 09.10.2023		part. no. 210-D09-C63-4																		